



HOTEL FACT SHEET

Holiday Inn & Suites and Burger Theory
1471 Rock Creek Blvd.
Joliet, IL 60431
779-206-2915
dos@hijoliethotel.com

Melissa Helfert – Director of Sales

Welcome to Joliet’s newest Full-Service Hotel featuring Rock Creek Convention Center as well as a full-service restaurant and bar – Burger Theory. Located right off I-80 and Houbolt and minutes from I-55

Holiday Inn & Suites Joliet is your premiere getaway destination. Enjoy all the benefits of the IHG Rewards program.

ACCOMMODATIONS

120 tastefully decorated guestrooms featuring a wide array of amenities for your personal comfort and convenience. Rooms offer WIFI, 43” flat screen TV, microwave and mini fridge, Keurig Coffee maker, in room safes, alarm clock and radio.

GUEST SERVICES AND AMENITIES

On-site restaurant Burger Theory, bar and room service. Over-sized fitness center with 2,000 sq. ft. A steam room and yoga room. We have complimentary WIFI throughout the hotel. A Twenty four-hour business center and guest laundry.

MEETING FACILITIES

13,000 sq. ft. of flexible meeting space including a 6,200 sq. ft. ballroom, three breakout rooms and boardroom. We have banquet menus that can be customized to your palette. Area for outdoor functions including weddings, receptions and other social gatherings.

LOCATION FEATURES

We are ten minutes from downtown Joliet and the Rialto Square Theater. Minutes from the Joliet Historical Museum and Joliet Slammers Field. A short drive to Harrah’s Casino or Hollywood Casino. We are also 15 minutes from Chicagoland Speedway and Route 66 Raceway.



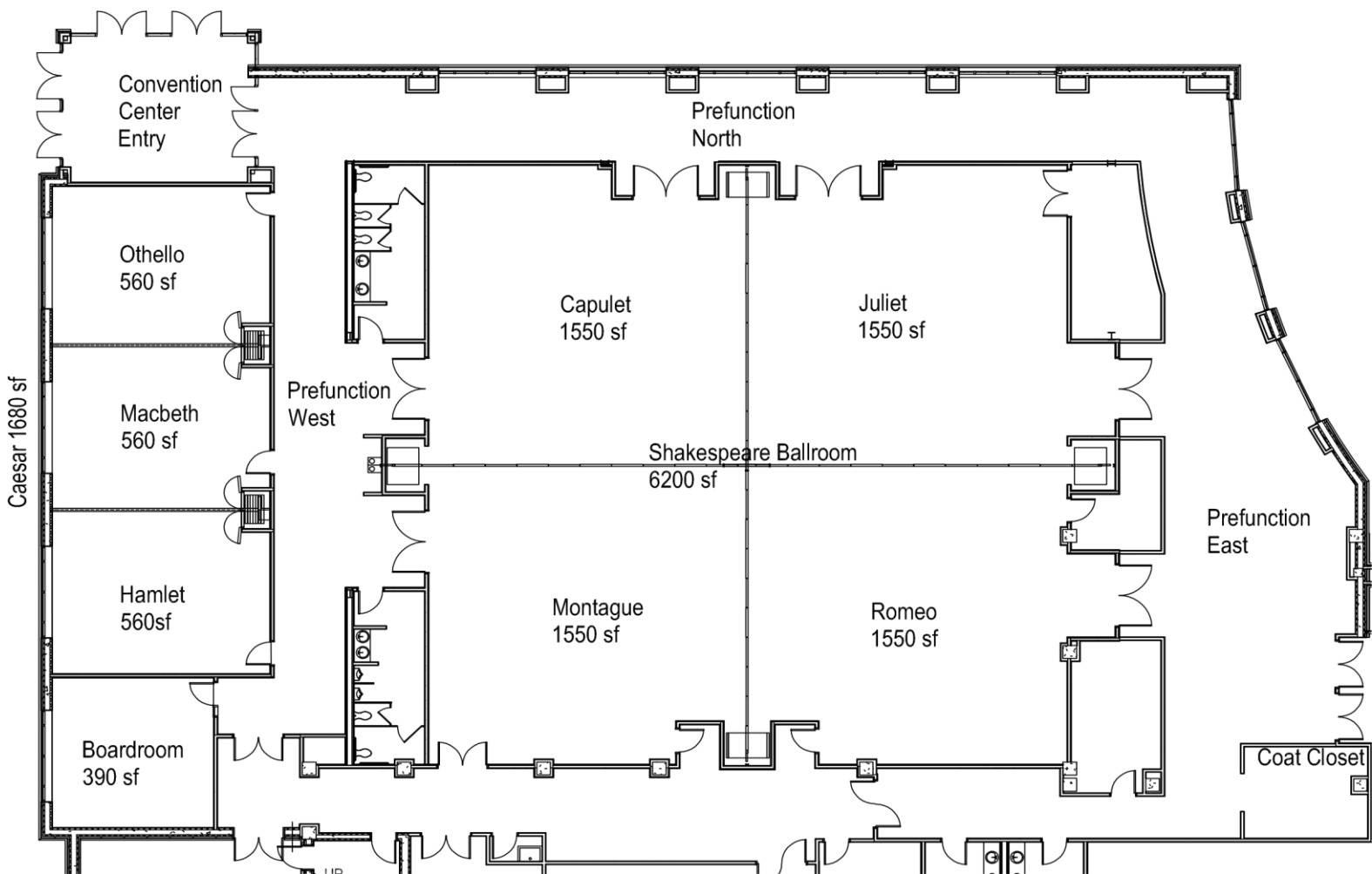

5,048 SQ. FT. OF PREFUNCTION SPACE AROUND SHAKESPEARE BALLROOM

Meeting Room	L x W	Sq. Ft.	Theater	Classroom	Banquet	Reception	Conference
Shakespeare Ballroom	78x79.5	6200	680	260	500	620	
Capulet	39'5x39	1550	170	65	125	155	51
Juliet	39'5x39	1550	170	65	125	155	51
Montague	39'5x39	1550	170	65	125	155	51
Romeo	39'5x39	1550	170	65	125	155	51
Caesar Ballroom	63x26.6	1680	190	85	139	225	55
Othello	21x26'6	560	64	28	46	60	18
Macbeth	21x26'6	560	64	28	46	60	18
Hamlet	21x26'6	560	64	28	46	60	18
Boardroom	20x19'5	390					12